

FS (FSW) FIXING

Special expansion plug

FS



Special expansion plug with screw

FSW



Overview

The FS plug is a special plug to be used in multiple applications. It is made of nylon PA6 of excellent quality so as to guarantee the durability. It can be provided also with a galvanized, countersunk and cross-cut head screw, which is encoded as FSW.

Material

PA6 - Polyamide PA6.

Plug Dimensions

FS06

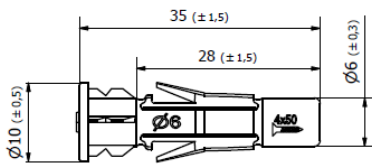

FS08

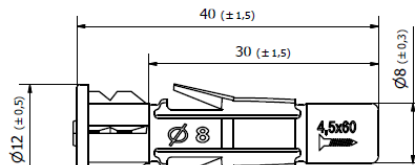

FS10

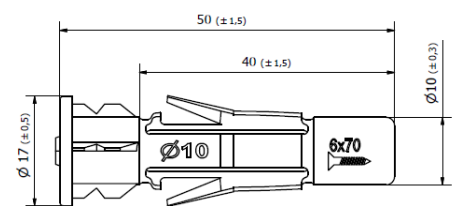

PLUG FA (FAW) DIMENSIONS

Code	D	L	Screw ØxL
FS06	6	35	Recommended Ø 4
FS08	8	40	
FS10	10	50	
FSI06	6	35	4
FSI08	8	40	
FSI10	10	50	
FSW06	6	35	4x50
FSW08	8	40	4,5x60
FSW10	10	50	6x70

Note: All dimensions are expressed in millimeters, unless otherwise stated.

Rev.2 20/09/2021 Bartolucci reserves, in order to improve the products, the right to modify at any time and without notice the data contained in this document.



Benefits

- The anti-rotation wings the wings make the fixing stable during installation.
- The collar at the bottom of the plug doesn't allow the dowel to penetrate the hole completely.
- Wide range of temperatures (between -40°C and +80°C).

Applications

- Hollow walls.
- Concrete.

Able to fix medium-low loads such as: chandeliers, bathroom fixtures, pictures, electrical panels.

Packaging Informations

Code	Pcs/Box	Box/Carton	Carton/Pallet
FS06	200	36	12
FS08	100	36	12
FS10	50	24	12
FSI06	20.000	1	12
FSI08	10.000	1	12
FSI10	5.000	1	12
FSW06	100	24	12
FSW08	50	24	12
FSW10	50	24	12

Loads

MECHANICAL STRENGTH [kN]

Code	Tensile strength on solid brick	Tensile strength on concrete R250	Tensile strength on hollow wall
FS06	0,7	0,9	0,8
FS08	1,5	1,8	1,0
FS10	1,8	2,8	1,6

Note: 1 kN=100 kgf

The reported values are mean values obtained from internal tests.

WE RECOMMEND USING APPROPRIATE SAFETY COEFFICIENTS.

Installation

- Drill the hole with a suitable diameter bit;
- Insert the plug (if close to the edge, let the expansion take place parallel to the edge);
- Rest the load to be fixed to the wall;
- Insert the screw and screw until the load is tightened.

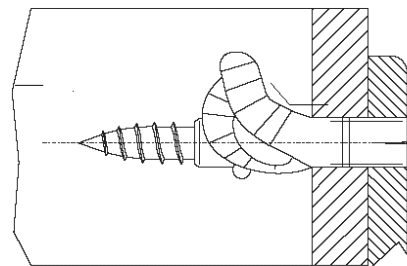

Rev.2 20/09/2021 Bartolucci reserves, in order to improve the products, the right to modify at any time and without notice the data contained in this document.

