

FAV-P : Hammer fixing with mushroom head and composite polymer nail



FIAV 6X37 PM6 and FFAV 6X37 PM6: Impact fasteners with high performance composite polymer nail with M6 male threaded head

FIAV 6X40 PM6



FFAV 6X37 PM6



Features

New Nylon fixing with rounded head and pre-assembled nail in thermoplastic-fiberglass composite for percussion installation. Designed for applications in environments exposed to humidity and/or salt spray and therefore solve the problem of oxidation of fixings with metal components. Ideal for fixing perimeters, drainage channels. Available in a brown body version for combinations with copper sheet metal. Excellent solution also for the electrical/electrotechnical sector as it allows the fixing of electrical boxes without the use of metal components. For fastening insulating panels, minimize thermal bridging thanks to the composite polymer nail.

The PM6 versions are designed for fixing flanges with M6 fixing. Excellent for environments exposed to humidity and therefore solve the problem of oxidation of fixings with metal components.

The gray version is made with a countersunk head plug while the Brown/black version has a dowel with a rounded head.

Advantages

- Maximum resistance to moisture suitable for saline environments.
- Deletion of thermal bridge comparing to the hammer fixings with metal screw
- Wide range of temperatures -40°C / +80°C.
- Speed of installation.

Base Materials

- Brick
- Hollow brick
- Concrete

Applications

- Specific for outdoor use.
- Tinsmithery.
- Electrical fixings.
- Pipe fixing.

Materials

Fixing : Polyamide PA6 (according to REACH and RoHS directives).

Nail : PA6 - Fiberglass composite.

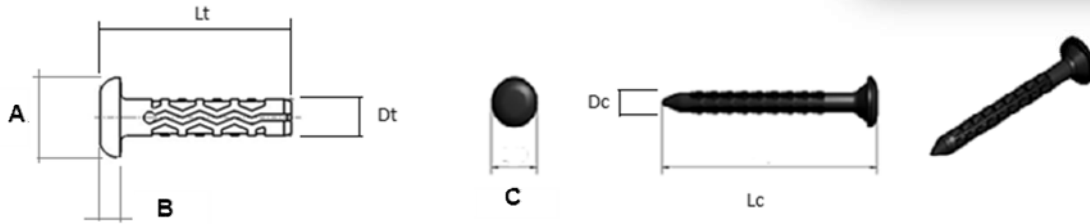
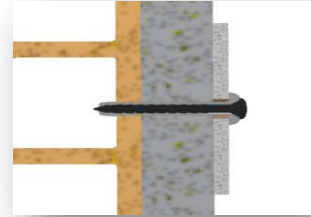

Code	Lt	Dt	A	B	Lc	Dc	C	Color
	mm	mm	mm	mm	mm	mm	mm	
FAV5x27P	27,5	5	11	3	29	3,5	7,2	Fixing grey RAL 7035 - Nail gray RAL 7035
FFAV5x27P	27,5	5	11	3	29	3,5	7,2	Fixing Brown RAL 8019 - Nail Black RAL 9005
FAV6x30P	30	6	13	3	30	4	8,5	Fixing grey RAL 7035 - Nail gray RAL 7035
FFAV6x30P	30	6	13	3	30	4	8,5	Fixing Brown RAL 8019 - Nail Black RAL 9005
FAV6x37P	38	6	13	3	40	4	8,5	Fixing grey RAL 7035 - Nail gray RAL 7035
FFAV6x37P	38	6	13	3	40	4	8,5	Fixing Brown RAL 8019 - Nail Black RAL 9005



Code	D C	L plug	Ls	D T	Dc	L C	L M	Color
	mm	mm	mm	mm	mm	mm	mm	
FIAV 6X40 PM6	6	40	35	11	4	39	7	Fixing grey RAL 7035 - Nail gray RAL 7035



Code	D C	L plug	Ls	D T	Dc	L C	L M	Color
	mm	mm	mm	mm	mm	mm	mm	
FFAV 6X37 PM6	6	39	35	14	4	39	7	Fixing Brown RAL 8019 - Nail Black RAL 9005

DoP - Recommended Loads

(1kN = 100 kgF)

Code	Pull- out		Shear	Tool diameter for drilling	Maximum fixing thickness
	Nrecomm. on concrete C20/25	Nrecomm. on hollow brick			
	Drilling Rotation - Percussion	Rotation Drilling	Vracc.		
	kN	kN	kN	mm	mm
F...5X27P	0,12	0,1	0,09	5	3
F...6x30P	0,15	0,11	0,11	6	5
F...6x37P	0,15	0,13	0,11	6	5
FFAV6X37PM6	0,15	0,13	0,11	6	5
FAV6X40PM6	0,15	0,13	0,11	6	5

On hollow Materials :

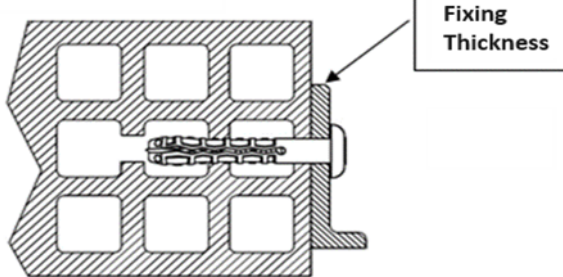

On Concrete :

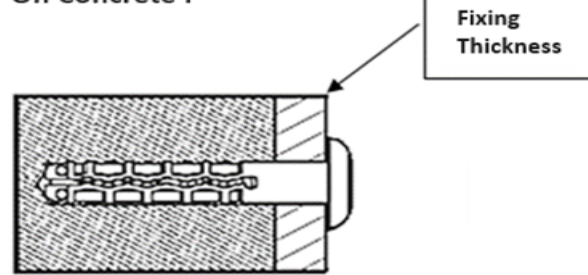

Notes on Loads

The limit resistance values have been determined through tests carried out in the internal BARTOLUCCI laboratory with specific measuring equipment. The recommended resistance values take into account safety coefficients in accordance with the guidelines expressed in the EOTA TR064 document. These values correspond to use with static load conditions specified for each support material. The resistance capacity of an isolated anchor to bending stresses is poor, therefore its application is not recommended. If there are situations in which there are dynamic stresses, the application must be tested for each specific case as it is very difficult to express general predictions.

Notes for a correct installation method

The installation method significantly influences the sealing performance expressed by a dry fastening system.

DIAMETER AND EXECUTION OF THE HOLE. The diameter of the hole for housing a plug is indicated in the technical data sheet. Poor stability of the drilling operations can cause oscillations during the execution of the hole, which could result in an excessively ENLARGED, CONICAL and/or OVALIZED hole, and consequently compromise the sealing performance of the fastening.

QUALITY OF THE SUPPORT. Since plugs are generally used to fix objects with various construction materials, the quality and condition of the materials themselves is fundamental. If the support material is CRACKED or has VOIDS, the sealing action of an expansion plug will be compromised.

CLEANING OF THE SEAT. Even if dry systems are less sensitive to the presence of dust and particulate matter inside the installation site of the anchor than connection systems that use adhesives and/or reactive resins, the installation hole must still be thoroughly cleaned before inserting the anchor. The presence of dust and particulate matter has a negative influence on the adhesion capacity of the fixing with the support.

NON-INTERFERENCE WITH OTHER STRUCTURAL ELEMENTS. During the drilling phases, it is necessary to pay attention to the point where the hole is made, especially in reinforced concrete. If any reinforcement elements, such as reinforcing bars, are intercepted, this may cause damage to the static and/or dynamic performance of the structure itself.

Packaging

Boxes	Code	Pcs / box	Box / Carton	Carton / Pallet	Pcs / Pallet
	FAV5X27P	200	36	30	216000
	FFAV5X27P	200	24	30	144000
	FAV6X30P	200	24	30	144000
	FFAV6X30P	200	24	30	144000
	FAV6X37P	200	24	30	144000
	FFAV6X37P	200	24	30	144000

EURO pallet 80x120 maximum height 1,95 meters.

Cartons	Code	Pcs / Carton	Carton / Pallet	Pcs / Pallet
	FAV5X27P	10000	30	300000
	FFAV5X27P	10000	30	300000
	FAV6X30P	6000	30	180000
	FFAV6X30P	6000	30	180000
	FAV6X37P	5000	30	150000
	FFAV6X37P	5000	30	150000

EURO pallet 80x120 maximum height 1,45 meters.

Boxes	Code	Pcs / box	Box / Carton	Carton / Pallet	Pcs / Pallet
	FFAV6X37PM6	200	24	30	144000
	FIAV6X40PM6	200	24	30	144000

EURO pallet 80x120 maximum height 1,95 meters.

Handling

Store in the original packaging in a covered and dry place.

Safety Instructions

According to the current European regulations, the articles in question do not require a Safety Data Sheet (Reg.1906/2007/CE - REACH). During application, the use of gloves, dust mask and protective glasses is recommended. Follow the safety regulations in place in the workplace.

Warnings

The data reported correspond to our current technical and applicative knowledge for an appropriate use of the product and are to be considered, in any case, indicative and general, therefore not binding for the same. It is recommended to carry out a preliminary practical test in order to verify the suitability of the product in relation to the intended use, purpose and its use. The person in charge of the construction site is responsible for verifying the suitability and correct implementation of the products described in this document for the use and purposes it intends.